



# VIBROLLER®

## Pneumatic Roller Vibrators

The patented **VIBROLLER® Pneumatic Roller Vibrator** features a roller that produces ten vibrations for each revolution inside the cylinder case. This design principle of operation drastically reduces the wear factor. Available in sizes and styles to meet any job.



### BDR Series

Small and lightweight to fill a multitude of application needs. Maximum VPM ranges from 19,000 to 26,000 with power to handle bins with material in excess of 2,000 pounds in the sloped portion. This unique dual-mount bracket offers a wide choice of mount position and vibration direction. Tapped exhaust allows unit to be equipped with muffler/regulator for quiet, controlled vibration to fill your needs.

### CVR Series

Available in two sizes, both with a two-hole mount. Frequency range is from 8,000-26,000 vpm, developing a maximum of 540 pounds of force. The CVR Series can be matched to containers with up to 5,400 pounds of material in the sloped portion.

### UCVR Series

Tapped inlet and exhaust ports for complete air control. Exhaust air can be piped from the area or muffled. Quiet power for effective vibration.

The UCVR Series is available in a wide range of sizes to meet a multitude of applications needs. With forces to 3,000 pounds, this vibrator is capable of moving material in bins with up to 30,000 pounds in the sloped portion.

### SPECIFICATIONS

Model	P/N Assembly	P/N Air Muffler	Unbalance lb-in.	Test Data	
				VPM* *	db *
CVR-10	14653	31623	0.003	—	—
CVR-19	23879	31623	0.05	13,500	85
BDR-10	15729	31622	0.003	18,200	85
BDR-13	18018	31623	0.008	22,000	85
BDR-16	17956	31623	0.02	13,300	85
UCVR4-05	13242	31623	0.05	13,500	85
UCVR6-5	13243	31624	0.5	7350	85
UCVR8-2.0	13244	19665	2.0	4900	85
UCVR8-8	16095	19665	0.8	6400	85

\* Decibels measured with muffler connected to exhaust port and vibrator securely mounted on test block.  
 \*\* Vibrations per minute (VPM) represents highest speed vibrator can attain and produce 85 db or less. (Note: Test is a comparison of vibrators. Levels will vary with each application.)

**PERFORMANCE DATA**

Model	40 psi (2.76 bar)			60 psi (4.14 bar)			80 psi (5.51 bar)			Max. lb material in slope of bin*
	vpm	Force lb (kg)	cfm (L/min)	vpm	Force lb (kg)	cfm (L/min)	vpm	Force lb (kg)	cfm (L/min)	
CVR-10	23,000	45 (20)	2 (57)	25,000	53 (24)	2 (57)	26,000	58 (26)	4 (113)	580
CVR-19	11,000	172 (78)	5 (142)	14,500	299 (136)	10 (283)	19,500	540 (245)	14 (396)	5400
BDR-10	23,000	45 (20)	2 (57)	25,000	53 (24)	2 (57)	26,000	58 (26)	4 (113)	580
BDR-13	22,000	110 (50)	2 (57)	24,000	131 (59)	4 (113)	25,000	142 (64)	6 (170)	1420
BDR-16	13,500	104 (47)	3 (85)	17,000	164 (74)	5 (142)	19,000	205 (93)	7 (198)	2050
UCVR4-05	11,000	172 (78)	5 (142)	14,500	299 (136)	10 (283)	19,500	540 (245)	14 (396)	5400
UCVR6-5	8000	910 (413)	15 (425)	10,000	1421 (645)	21 (595)	10,500	1566 (710)	29 (821)	15,200
UCVR8-2.0	5600	1782 (808)	35 (991)	6150	2150 (975)	46 (1303)	7000	2785 (1263)	60 (1699)	28,000
UCVR8-8	10,000	2273 (1031)	40 (1133)	10,500	2506 (1137)	46 (1303)	11,500	3006 (1364)	52 (1473)	30,000

\* **Rule-of-thumb vibrator sizing:** One pound of vibrator force for every ten pounds of product in the sloped section of the bin content. Mount vibrator as close as possible to material outlet. Reinforce mount area to prevent flexure of bin wall at mount location.

**DIMENSIONS—IN. (MM)**

Model	A	B	C	D	E	F	G	H*	J	K**	L	M
CVR-10	3.9 (99)	2.0 (51)	1.3 (32)	1.3 (32)	0.6 (15)	3.0 (76)	0.3 (6)	0.3 (8)	0.8 (19)	0.1 (3)	1.7 (42)	1.1 (27)
CVR-19	5.1 (130)	3.1 (80)	1.2 (49)	2.1 (54)	0.8 (21)	4.0 (102)	0.4 (10)	0.4 (10)	1.3 (33)	0.3 (6)	2.6 (65)	1.8 (44)
BDR-10	3.1 (80)	1.9 (48)	1.3 (32)	1.3 (33)	0.6 (15)	1.4 (35)	0.3 (6)	0.3 (8)	1.1 (29)	0.1 (3)	1.2 (30)	—
BDR-13	3.8 (95)	2.1 (54)	1.5 (37)	1.6 (41)	0.6 (16)	1.6 (40)	0.3 (8)	0.4 (10)	1.1 (29)	0.3 (6)	1.3 (32)	—
BDR-16	4.1 (105)	2.6 (65)	1.7 (43)	1.7 (43)	0.8 (21)	1.8 (46)	0.4 (10)	0.4 (10)	1.3 (32)	0.3 (6)	1.6 (41)	—
UCVR4-05	5.0 (127)	3.4 (86)	1.9 (49)	1.9 (48)	1.8 (45)	4.0 (102)	0.4 (10)	0.4 (10)	0.9 (24)	0.3 (6)	—	—
UCVR6-5	7.8 (197)	5.2 (132)	4.1 (103)	2.9 (73)	2.9 (74)	6.0 (152)	0.6 (14)	0.6 (16)	1.9 (48)	0.4 (10)	—	—
UCVR8-2.0	10.0 (254)	6.9 (175)	4.0 (102)	3.8 (95)	4.1 (103)	8.0 (203)	0.8 (19)	0.8 (19)	2.8 (71)	0.8 (19)	—	—
UCVR8-8	10.0 (254)	6.9 (175)	4.0 (102)	3.8 (95)	4.1 (103)	8.0 (203)	0.8 (19)	0.8 (19)	2.8 (71)	0.8 (19)	—	—

\* Bolt Size    \*\* Pipe Tap Size

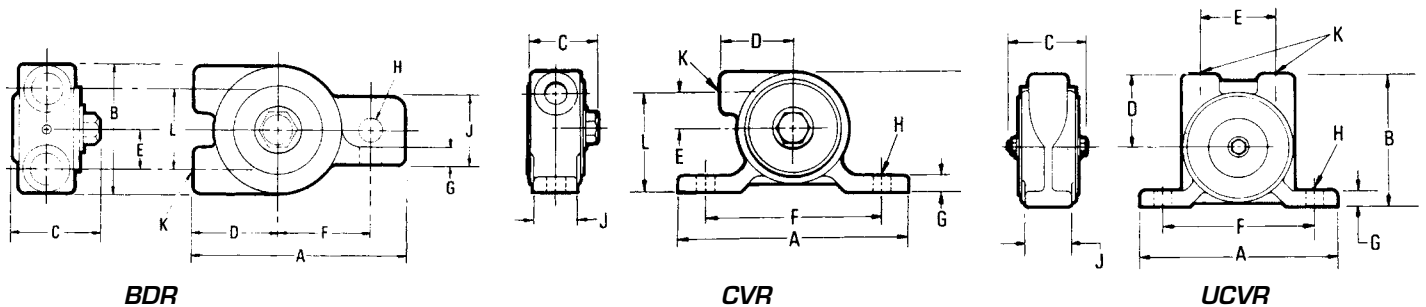

See the operator's manual for application information and mount selection.



Patents and patents pending. © Registered trademark of Martin Engineering Company in the U.S. and other select locations. Additional information can be obtained at [www.martin-eng.com/trademarks](http://www.martin-eng.com/trademarks).

**QUALITY MANAGEMENT SYSTEM  
CERTIFIED BY DNV**  
**ISO 9001**

**MARTIN ENGINEERING USA**  
One Martin Place  
Neponset, IL 61345-9766 USA  
800-544-2947 or 309-594-2384  
FAX: 309-594-2432  
[www.martin-eng.com](http://www.martin-eng.com)